

Thank you for purchasing this door stop kit!

Full color instructions can be viewed online here:

<http://www.nortonfab.com/?product=sprinter-van-door-stop>

Things you will need for this installation:

- Your awesome fantastic amazing fancy new door stop (included of course! It's wrapped in foam around the Popsicle stick to protect it)
- (2) Alcohol wipes (included)
- Wooden stir stick for epoxy (included)
- A small square of grey Scotchbrite abrasive pad (included)
- JB Weld original 2 part epoxy
- Something to mix the epoxy on such as a small piece of cardboard
- A sharpie or some masking tape to mark the location of the stop on the door track
- A few paper towels in case you need to wipe your hands or clean up excess epoxy
- A buddy to hold the Sprinter van door
- A bench or space to work that is close to your van so when you apply the epoxy to the door stop, you don't have far to carry the door stop to the van.



IMPORTANT

The JB Weld epoxy cures slowly, and can take up to 6 hours to set, however it is still important to read through all directions and review all pictures before you begin to familiarize yourself with the process and be sure you have everything you need.

The epoxy is meant to be permanent, however, once the door stop is glued down and the epoxy has cured, the door stop can be removed by placing a sharp edge like a chisel under the left or right edge, and tapping gently with a hammer. Once it breaks loose, use the sharp edge of the chisel, a razor blade, or fine grit sandpaper to scrape off any remaining epoxy.

This product is sold as a do-it-yourself kit with no guarantees or warranty. Use this product at your own risk.

Step 1

Have a buddy hold the Sprinter van sliding door open about 1/3 of the way and locate the roller that rides on the track on the left side of the door at about chest level. It is slightly behind the left edge of the door.



Step 2

With your buddy's help holding the door, decide exactly how far open you want the door to be when it rests in the new door stop, then have your buddy hold the door in this position. Use a sharpie to put a small mark on the aluminum track just below the center of the roller on the left side (you will use this mark to align the position of the stop). Place a second mark on the track about 4" to the left of the roller, but in line with the center of the roller (you will use this mark to be sure the stop is in line with the roller wheel). Then close the van door.



Step 3

Use the small square of grey scotchbrite abrasive pad to scuff the backside of the door stop, then scuff the track of the sprinter van in the area where the doorstop will be glued between the two sharpie marks. This is fine grit scotchbrite pad, so you can scuff it pretty aggressively before it will leave much of a mark on the aluminum door stop and roller track. This is to remove oxidation and improve the bond of the epoxy. Try to only scuff the small area that the doorstop will cover so it doesn't look ugly once you install the door stop.

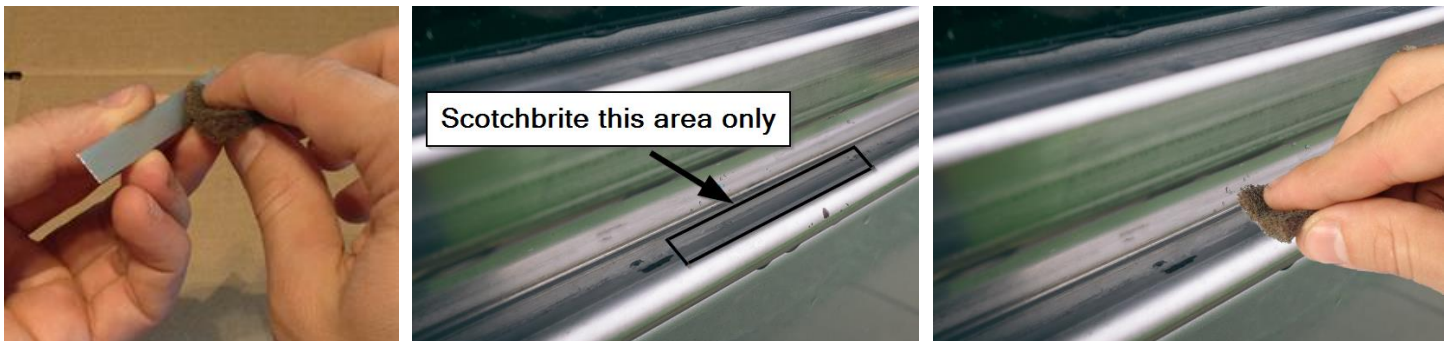

Step 4

Open one of the alcohol wipes and first wipe off the bottom side of the door stop, then use the wipe to clean the area on the door track where you just scuffed it with the scotchbrite abrasive pad. The alcohol will quickly evaporate leaving the area clean. Be sure to clean a wide enough area for the entire door stop to sit on the clean track, but do not wipe off the sharpie marks!

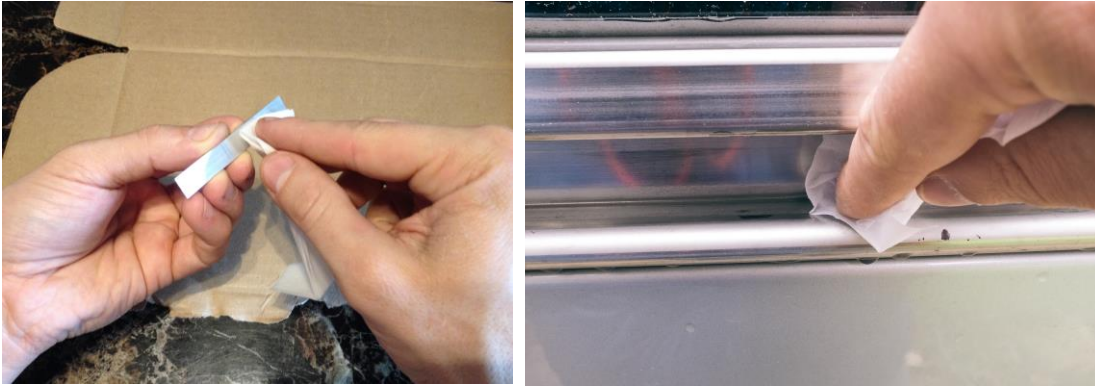

Step 5

Now it's time to mix the epoxy and apply it to the door stop for mounting. Read through all of these directions and review all photos before you begin to familiarize yourself with the process. JB Weld original epoxy takes 4-6 hours to set, and 24 hours to cure.

- a. JB Weld includes 2 tubes, one containing resin, and one containing hardener.



- b. Squeeze out a small dab of each tube onto the cardboard, then mix them thoroughly until the mix is an even grey color.



- c. Spread a small amount of the mixed epoxy on the bottom (flat side) of the door stop, then use the edge of the popsicle stick to wipe most of it off, leaving only a thin even layer so it doesn't squish out the sides when you install it and make a big mess on your door track.

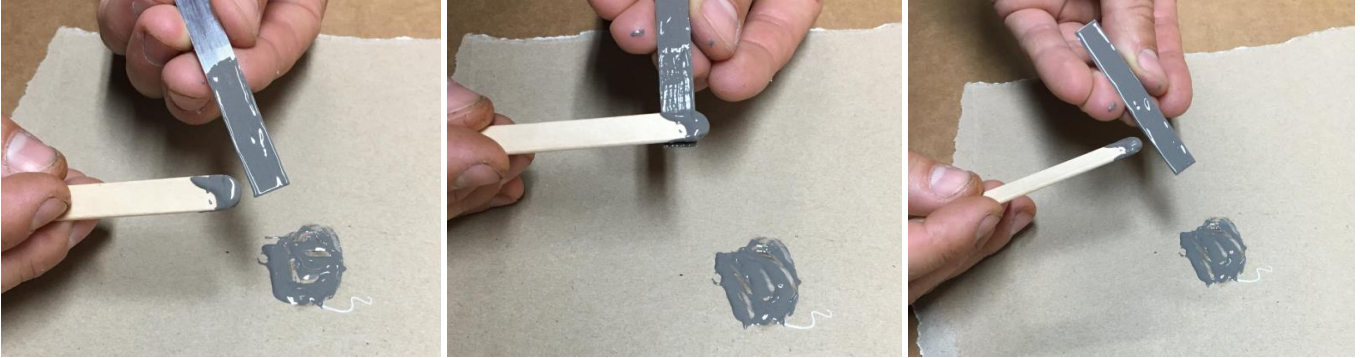

Step 6

Place the door stop on the door track (with the epoxy side down obviously!) so that the center detent is in line with your sharpie mark on the front of the track, and the entire door stop is in line with the sharpie mark to the left side of the stop (so the roller will roll down the center of the entire door stop). Try to get the stop close to the correct position when you first place it, and only twist it or slide it as little as necessary to get it into place. Once it is in the correct position, press down lightly to be sure the epoxy makes good contact over the entire surface. Use the second alcohol wipe to carefully clean off the sharpie marks and any epoxy mess, then leave the door stop alone for 24 hours so it will cure.

DO NOT ROLL THE DOOR OVER OR ONTO THE DOOR STOP UNTIL IT HAS CURED FOR 24 HOURS!!!

